

HOW DOES PM WRITING SUPPORT THE DfE WRITING FRAMEWORK?

Provides an evidence-based, structured approach to teaching and learning

- ✓ PM Writing helps pupils **manage the complex demands of writing** through an explicit, sequenced and text type structured approach in a meaningful context

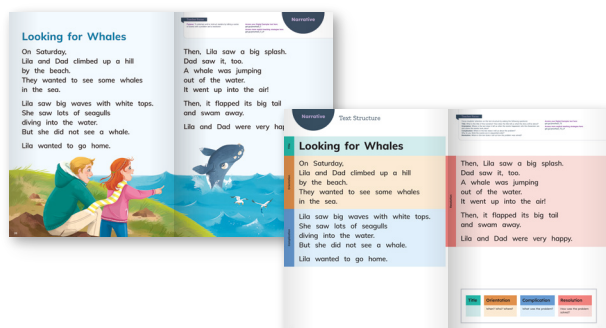

Focuses on quality over quantity

- ✓ PM Writing focuses on writing **well and meaningfully** before consolidating and extending children's skills
- ✓ **Explicitly links reading and writing** by using exemplar texts across a range of text types

Rethinks writing assessments

- ✓ Provides teachers with in-built **formative and summative assessment tools to assess for learning** and avoid stifling children's creativity

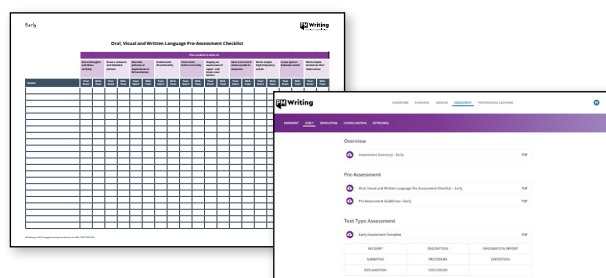

Builds on foundational speaking, listening skills in Reception and Key Stage 1

- ✓ Starts developing children's skills from Reception
- ✓ Demands oral composition and rehearsal before writing
- ✓ Emphasises the importance of oral literacy, handwriting, spelling, punctuation, and sentence construction within meaningful and purposeful contexts

Supports all learners

- ✓ Helps **identify children who need more support** and provides differentiated learning pathways
- ✓ Scaffolds learning with teacher support materials for pupils who struggle with oral composition and writing

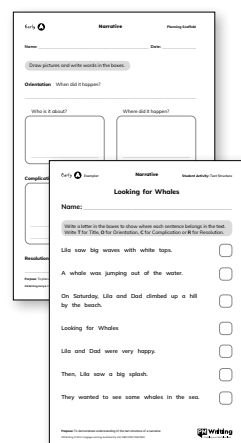

Provides extensive professional support

- ✓ Supports school leaders to **ensure all staff are trained to teach writing** through a school-wide, consistent approach to writing from EYFS through to Key Stage 2
- ✓ In-built training within the portal offers daily support for teachers
- ✓ School-based 1-2-1 training available

